

SECTION F - TABLE OF CONTENTS

Section F Contents:

PRO Standards, Brackets & Pilasters..... 2 - 3

KV Single Slot Standards & Brackets..... 4 -11

KV Double Slot Standards & Brackets.....12 -15

KV Pilasters..... 16 -18

Reeve Recessed Standards & Brackets..... 19

Reeve Single Slot Standards & Brackets..... 20 - 23

Reeve Double Slot Standards & Brackets..... 23

Reeve Standard & Bracket Accessories..... 24

Reeve Slatwall Accessories..... 24

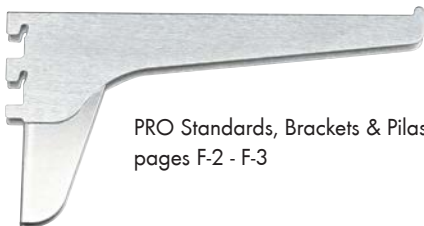

PRO Standards, Brackets & Pilasters
pages F-2 - F-3

KV Standards, Brackets & Accessories
pages F-4 - F-15 ↓



↑ KV Pilasters & Accessories
pages F-16 - F-18



Reeve Standards & Brackets
F-19 - F-24

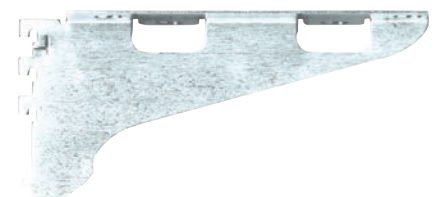

A

B

C

D

E

F

G

H

I

J

K

L

M

N

O

P

Q

R

S

T

U

V

W

X

Y

A
B
C
D
E
F
G
H
I
J
K
L
M
N
O
P
Q
R
S
T
U
V
W
X
Y

PRO STANDARDS & BRACKETS

PRO Value Single Standards

- ANSI/BHMA Grade II rated single standards
- Standard single slots are spaced in 2" increments
- Material: Heavy Duty 12-gauge steel
- Finish: Zinc
- Dimensions: 7/8"W x 11/16"D
- Packaging: Full boxes of 10 standards.
Available any quantity.

Standard Item #	Size
DSPROSSNGL-24ZC	24"
DSPROSSNGL-30ZC	30"
DSPROSSNGL-36ZC	36"
DSPROSSNGL-48ZC	48"
DSPROSSNGL-60ZC	60"
DSPROSSNGL-72ZC	72"
DSPROSSNGL-84ZC	84"
DSPROSSNGL-96ZC	96"



PRO Value Single Brackets

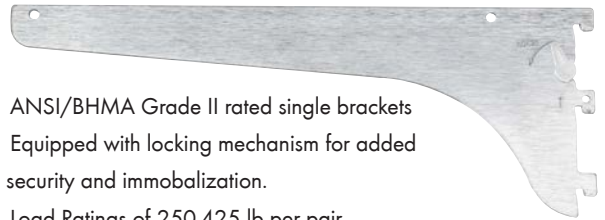

- ANSI/BHMA Grade II rated single brackets
- Equipped with locking mechanism for added security and immobilization.
- Load Ratings of 250-425 lb per pair (based on length of bracket)
- Material: Heavy Duty 12-gauge steel
- Finish: Zinc
- Packaging: Full boxes of 20 brackets. Available any quantity.

Bracket Item #	Size
DSPROBSNGL-8ZC	8"
DSPROBSNGL-10ZC	10"
DSPROBSNGL-12ZC	12"
DSPROBSNGL-14ZC	14"
DSPROBSNGL-16ZC	16"
DSPROBSNGL-18ZC	18"
DSPROBSNGL-20ZC	20"
DSPROBSNGL-22ZC	22"
DSPROBSNGL-24ZC	24"

PRO Value Premier Double Standards

- ANSI/BHMA Grade II rated double standards
- Standard double slots are spaced in 1" increments
- Pre-drilled for ease of installation and a smooth finish
- Material: 14-gauge steel
- Finish: White
- Dimensions: 1.05" W x 0.69" D
- Packaging: Full boxes of 10 standards.
Available any quantity.

Standard Item #	Size
DSPROSPRDBL-16WH	16.5"
DSPROSPRDBL-28WH	28"
DSPROSPRDBL-39WH	39"
DSPROSPRDBL-48WH	48"
DSPROSPRDBL-63WH	63"
DSPROSPRDBL-78WH	78"
DSPROSPRDBL-94WH	94"

PRO Value Premier Double Brackets



- ANSI/BHMA Grade II rated double brackets
- Load Ratings of 200-425 lb per pair (based on length of bracket)
- Material: 14-gauge steel
- Finish: White
- Packaging: Full boxes of 10 brackets. Available any quantity.

Bracket Item #	Size
DSPROBPRDBL-5WH	5"
DSPROBPRDBL-7WH	7"
DSPROBPRDBL-9WH	9"
DSPROBPRDBL-10WH	10.5"
DSPROBPRDBL-12WH	12.5"
DSPROBPRDBL-14WH	14.5"
DSPROBPRDBL-18WH	18.5"
DSPROBPRDBL-24WH	24.5"



PRO STANDARDS, BRACKETS & PILASTERS

A
B
C
D
E
F
G
H
I
J
K
L
M
N
O
P
Q
R
S
T
U
V
W
X
Y

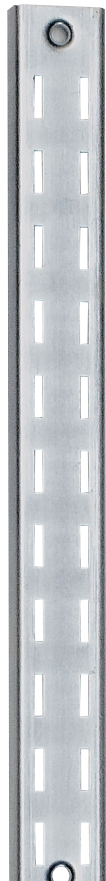

PRO Value Double Standards

- ANSI/BHMA Grade II rated double standards
- Standard double slots are spaced in 1" increments
- Material: 16-gauge steel
- Finish: Zinc
- Dimensions: 1-1/4" W x 1/2" D
- Packaging: Full boxes of 20 standards (sizes: 24" - 60") and 10 standards (sizes: 72" - 96"). Available any quantity.

Standard Item #	Size
DSPROSDBL-24ZC	24"
DSPROSDBL-36ZC	36"
DSPROSDBL-48ZC	48"
DSPROSDBL-60ZC	60"

Standard Item #	Size
DSPROSDBL-72ZC	72"
DSPROSDBL-84ZC	84"
DSPROSDBL-96ZC	96"

PRO Value Double Brackets

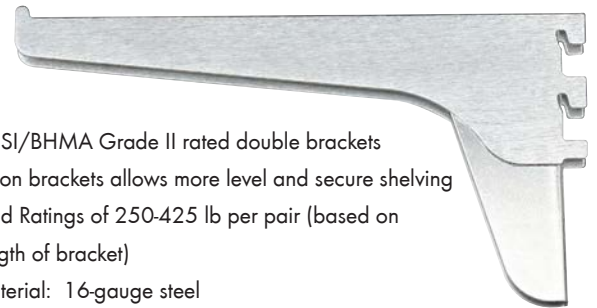

- ANSI/BHMA Grade II rated double brackets
- Lip on brackets allows more level and secure shelving
- Load Ratings of 250-425 lb per pair (based on length of bracket)
- Material: 16-gauge steel
- Finish: Zinc
- Packaging: Full boxes of 20 brackets. Available any quantity.

Bracket Item #	Size
DSPROBDBL-8ZC	8"
DSPROBDBL-10ZC	10"
DSPROBDBL-12ZC	12"
DSPROBDBL-14ZC	14"
DSPROBDBL-16ZC	16"
DSPROBDBL-18ZC	18"
DSPROBDBL-20ZC	20"
DSPROBDBL-22ZC	22"
DSPROBDBL-24ZC	24"



PRO Value Pilasters & Clip

- ANSI/BHMA Grade II rated single pilasters
- Designed to hold various shelf materials such as glass, particle board, and wood
- Spaced in 1/2" increments for stability
- Pre-drilled nail holes and stamped numbers for easy installation
- Finish: Zinc
- Load rating of 100 lb
- Packaging: Full boxes of 10 pilasters. Available any quantity.



Pilaster Item #	Size
DSPROPILSTR-18ZC	18"
DSPROPILSTR-24ZC	24"
DSPROPILSTR-30ZC	30"
DSPROPILSTR-36ZC	36"
DSPROPILSTR-48ZC	48"

Pilaster Item #	Size
DSPROPILSTR-60ZC	60"
DSPROPILSTR-72ZC	72"
DSPROPILSTR-84ZC	84"
DSPROPILSTR-96ZC	96"



Clip Item #	Box Qty	Clip Item #	Box Qty
DSPROCLIP-ZC	100	DSPROCLIP-BZC	1000

A
B
C
D
E
F
G
H
I
J
K
L
M
N
O
P
Q
R
S
T
U
V
W
X
Y

KV 80 / 180 REGULAR DUTY STANDARDS & BRACKETS

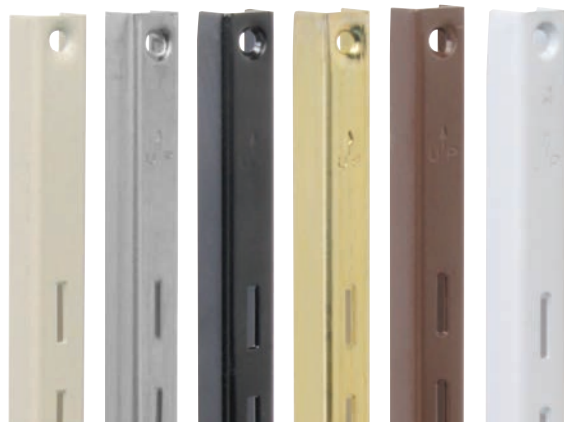

Almond Anochrome Black Brass-look Brown White

KV 80 Series Standards

- Single slot design
- 1" vertical slot adjustability
- BHMA Grade 2 Compliant
- Limited lifetime warranty
- Dimensions: 5/8" wide x 13/32" deep x selected length
- Material: 16 gauge steel
- Countersunk screw holes
- Safety lead-in at top of standards
- Embossed "up" and arrow to show correct orientation and precision cut lengths
- Center aligned slots and screw holes
- Packed 10 standards per box. Available any quantity.



Length	Almond Item #	Anochrome Item #	Black Item #	Brass-look Item #	Brown Item #	White Item #
12"	—	KV80A-12	—	—	—	KV80WH-12
18"	—	KV80A-18	—	—	—	—
24"	KV80ALM-24	KV80A-24	KV80BLK-24	—	—	KV80WH-24
36"	KV80ALM-36	KV80A-36	KV80BLK-36	KV80B-36	—	KV80WH-36
48"	KV80ALM-48	KV80A-48	KV80BLK-48	KV80B-48	KV80BN-48	KV80WH-48
60"	KV80ALM-60	KV80A-60	KV80BLK-60	KV80B-60	KV80BN-60	KV80WH-60
72"	KV80ALM-72	KV80A-72	KV80BLK-72	KV80B-72	KV80BN-72	KV80WH-72
84"	—	KV80A-84	—	—	—	—
96"	—	KV80A-96	KV80BLK-96	—	—	KV80WH-96



KV 180 Series Brackets

- For use with KV 80 series standards
- Material: 14 and 16 gauge steel
- Holds up to 320 lbs. per pair
- Two complete locking teeth
- Spring steel clip for stability and friction lock
- Shelf retaining clip
- Packed 10 brackets per box.
- Available any quantity.



Length	Almond Item #	Anochrome Item #	Black Item #	Brass-look Item #	Brown Item #	White Item #
4"	—	KV180A-4	—	—	—	—
6"	—	KV180A-6	KV180BLK-6	KV180B-6	—	KV180WH-6
8"	KV180ALM-8	KV180A-8	KV180BLK-8	KV180B-8	KV180BN-8	KV180WH-8
10"	KV180ALM-10	KV180A-10	KV180BLK-10	KV180B-10	KV180BN-10	KV180WH-10
12"	KV180ALM-12	KV180A-12	KV180BLK-12	—	KV180BN-12	KV180WH-12
14"	KV180ALM-14	KV180A-14	KV180BLK-14	KV180B-14	—	KV180WH-14
16"	—	KV180A-16	KV180BLK-16	KV180B-16	—	KV180WH-16
18"	—	KV180A-18	—	—	—	KV180WH-18
20"	—	KV180A-20	—	—	—	—

KV 80/180 SERIES STANDARD & BRACKET ACCESSORIES

KV 160LL Series Lock Lever Brackets

- For use with 1" adjustable 80 series standards
 - Material: 14 gauge steel
 - Finish: Anochrome (ANO)
 - Two locking teeth
 - Lever lock for extra secure mounting and stability
 - Shelf retaining lip
 - Packed 10 brackets per box.
- Available any quantity.



Length	Item #
6"	KV160A-6
8"	KV160A-8
10"	KV160A-10
12"	KV160A-12
14"	KV160A-14
16"	KV160A-16
18"	KV160A-18

KV 179 Series Adjustable Angle Brackets

- For use with 1" adjustable 80 series standards
- Material: 14 and 16 gauge steel
- Finish: Anochrome (ANO)
- Two complete locking teeth
- Shelf retaining clip
- Spring clip for stability and friction locking
- Adjusts to 15°, 30°, 45° and level
- Packed 10 brackets per box. Available any quantity.



Length	Item #
10"	KV179A-10
12"	KV179A-12
14"	KV179A-14

KV 80/180 Series Accessories

- Packed 100 per box.
- Available any quantity.

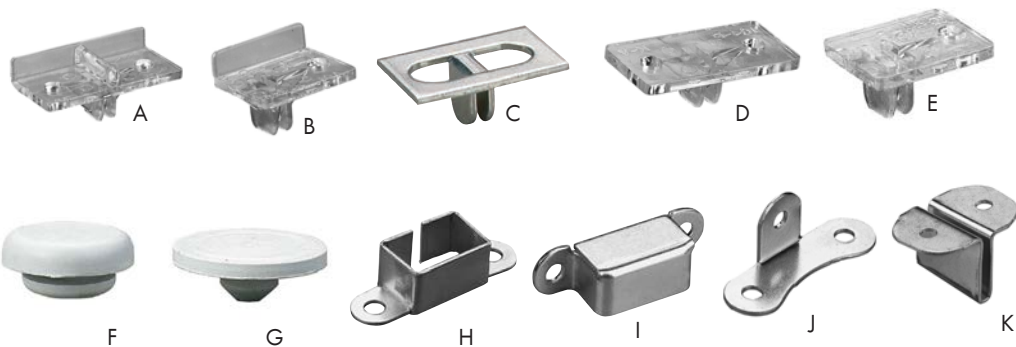

	Item #	Description
A	KV102-PLAS	Clear plastic front rest with divider
B	KV103PLAS	Clear plastic front rest
C	KV104ANO	Anochrome steel back rest
D	KV104-PLAS	Clear plastic back rest
E	KV104-1/2PLAS	Clear plastic back rest
F	KV119R	Gray rubber cushion to use with metal rests

	Item #	Description
G	KV129	Gray rubber cushion to use with plastic rests
H	KV136ANO	Socket-#80 standard bottom socket
I	KV137ANO	Socket-#80 standard top socket
J	KV153ANO	Standard fastener floor mount (bolt and nut not included)
K	KV154-ANO	Shelf fastener (fastens shelf to bracket)

A
B
C
D
E
F
G
H
I
J
K
L
M
N
O
P
Q
R
S
T
U
V
W
X
Y

A
B
C
D
E
F
G
H
I
J
K
L
M
N
O
P
Q
R
S
T
U
V
W
X
Y

KV 83/183 SERIES HEAVY-DUTY STANDARDS & BRACKETS



KV 83 Series Oversized Standards



- Single slot design
- 1" vertical slot adjustability
- BHMA Grade 2 Compliant
- Limited lifetime warranty
- Dimensions: 3/4" W x 1/2" D x selected length
- Material: 16 gauge steel
- Finish: Anochrome (ANO)
- Safety lead-in at top of standard
- Embossed logo to show correct orientation
- Countersunk screw holes
- Center aligned slots and screw holes
- Precision cut lengths
- Packed 10 standards per box. Available any quantity.

Length	Item #
24"	KV83A-24
36"	KV83A-36
48"	KV83A-48
60"	KV83A-60

Length	Item #
72"	KV83A-72
84"	KV83A-84
96"	KV83A-96

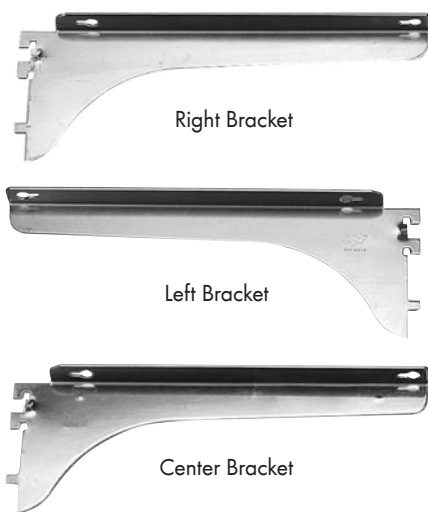

KV 183 Series Brackets



- For use with KV 83 series standards
- 183R: Right Flange Bracket
- 183L: Left Flange Bracket
- 183C: Center Flange Bracket
- Material: 16 gauge steel
- Finish: Anochrome (ANO)
- Holds up to 460 lbs. per pair of brackets
- Bracket flanges allows for simple attachment to wooden shelves
- Brackets may also be used with 85 series standards for added supports on long shelves
- Packed 10 brackets per box. Available any quantity.

Length	Right Bracket Item #	Left Bracket Item #	Center Bracket Item #
8"	KV183RA-8	KV183LA-8	KV183CA-8
10"	KV183RA-10	KV183LA-10	KV183CA-10
12"	KV183RA-12	KV183LA-12	KV183CA-12
14"	KV183RA-14	KV183LA-14	KV183CA-14
16"	KV183RA-16	KV183LA-16	KV183CA-16
18"	KV183RA-18	KV183LA-18	KV183CA-18
20"	KV183RA-20	KV183LA-20	KV183CA-20

KV 83/183 SERIES STANDARD & BRACKET ACCESSORIES



KV 113L/113R Panel Clips

- Used to attach display and wall panels into vertical position
- Finish: Anochrome
- Packed 50 per box.
- Available any quantity.



Item #	Description
KV113L-ANO	Left-Hand Anochrome Panel Clip
KV113R-ANO	Right-Hand Anochrome Panel Clip



KV 119 Gray Rubber Cushion

- Packed 100 per box.
- Available any quantity.

Item #
KV119R



KV134ANO



KV135ANO

KV 134/135 Sockets

- Packed 100 per box.
- Available any quantity.

Item #	Description
KV134ANO	#83 Standard Bottom Socket
KV135ANO	#83 Standard Top Socket



KV 159 Lock Lever Heavy-Duty Support Bracket

- Provides extra support for shelves with heavy loads
- Lever lock for extra secure mounting and stability
- Finish: Anochrome
- Packed 100 per box. Available any quantity.



Item #
KV159LL-ANO

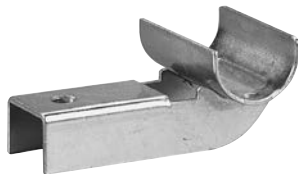

KV 191/192 Hang Rod Saddles

- 191 bolts to 183L & 183R or 185 brackets to hold 1-1/16" O.D. tubing
- 192 bolts to 183L & 183R or 185 brackets to hold 1-5/16" O.D. tubing
- Finish: Anochrome
- Packed 10 per box. Available any quantity.

Item #	Description
KV191ANO	To hold 1-1/16" O.D. tubing
KV192ANO	To hold 1-5/16" O.D. tubing



KV 161LL Lock Lever Brackets

- Finish: Anochrome (ANO)
- Three locking teeth
- Lever lock for extra secure mounting
- Packed 10 per box. Available any quantity.

Size	Item #
14"	KV161A-14
16"	KV161A-16
18"	KV161A-18
20"	KV161A-20
24"	KV161A-24

A KV 87 / 186 / 187 SERIES SUPER-DUTY STANDARDS & BRACKETS

B
C
D
E
F
G
H
I
J
K
L
M
N
O
P
Q
R
S
T
U
V
W
X
Y



Anochrome

White

KV 87 Series Standards

- Single slot design
- 2" vertical slot adjustability
- BHMA Grade 2 Compliant
- Limited lifetime warranty
- Dimensions: 7/8" wide x 11/16" deep x selected height
- Material: 12 gauge steel
- Finish: Anochrome (ANO), White (WH)
- Embossed logo to show correct orientation
- Countersunk screw holes
- Center aligned slots and screw holes
- Precision cut lengths
- Packed 5 standards per box. Available any quantity.



Length	Anochrome Item #	White Item #
24"	KV87A-24	KV87WH-24
36"	KV87A-36	KV87WH-36
48"	KV87A-48	KV87WH-48
60"	KV87A-60	KV87WH-60
72"	KV87A-72	KV87WH-72
84"	KV87A-84	KV87WH-84
96"	KV87A-96	KV87WH-96



186 Series Anochrome

186 Series White

KV 186LL and 187LL Series Lock Lever Brackets

- For use with KV 87 series standards
- Material: 12 gauge steel
- Finish: Anochrome (ANO), White (WH)
- Holds up to 1,060 lbs. per pair of brackets
- Utilizes an easy-to-install unique cam lock that secures bracket to the standard
- Two or three complete locking teeth
- Predrilled holes for mounting 1987 series shelves or attaching shelf rests
- Packed 10 brackets per box. Available any quantity.



187 Series Anochrome

187 Series White

186 Series Brackets		
Length	Anochrome Item #	White Item #
8"	KV186A-8	KV186WH-8
10"	KV186A-10	KV186WH-10

187 Series Brackets		
Length	Anochrome Item #	White Item #
12"	KV187A-12	KV187WH-12
14"	KV187A-14	KV187WH-14
16"	KV187A-16	KV187WH-16
18"	KV187A-18	KV187WH-18
20"	KV187A-20	KV187WH-20
22"	KV187A-22	KV187WH-22
24"	KV187A-24	KV187WH-24

KV 87 / 187 SERIES STANDARD & BRACKET ACCESSORIES



KV 119 Gray Rubber Cushion

- For use with metal rests
- Recommended for use when supporting glass shelves
- Packed 100 per box. Available any quantity.



Item #
KV119R

A
B
C
D
E
F



KV 129 Gray Rubber Cushion

- For use with metal and plastic rests
- Recommended for use when supporting glass shelves
- Packed 100 per box. Available any quantity.



Item #
KV129

G
H
I
J
K



KV210

KV Front and Center Rests

- Recommended for use with 186 and 187 series brackets
- For anchoring shelf to brackets
- Packed 100 per box. Available any quantity.



Item #	Description
KV210ANO	Anochrome End Rest with Screw
KV210WH	White End Rest with Screw
KV211ANO	Anochrome Center Rest with Screw
KV211WH	White Center Rest with Screw
KV212ANO	Anochrome Front Rest with Screw
KV212WH	White Front Rest with Screw
KV213ZC	Zinc Snap-in Center Rest

L
M
N
O
P
Q
R
S
T
U
V
W
X
Y



KV211



KV212



KV213

A
B
C
D
E
F
G
H
I
J
K
L
M
N
O
P
Q
R
S
T
U
V
W
X
Y

KV 87 / 186 / 187 SUPER-DUTY STAINLESS STEEL STANDARDS & BRACKETS



KV 87 Super-Duty Stainless Steel Standards



- Single slot design
- 2" vertical slot adjustability
- BHMA Grade 2 Compliant
- Limited lifetime warranty
- Dimensions: 7/8" wide x 1 1/16" deep x selected length
- Material: 14 gauge, 304 grade stainless steel
- Finish: Stainless Steel (SS)
- Countersunk screw holes
- Center aligned slots and screw holes
- Precision cut lengths
- Packed 5 standards per box. Available any quantity.

Length	Item #
24"	KV87SS-24
36"	KV87SS-36
48"	KV87SS-48
60"	KV87SS-60
72"	KV87SS-72



KV 186LL and 187LL Series Stainless Steel Lock Lever Brackets



- For use with KV 87 series stainless steel standards
- Material: 14 gauge, 304 grade stainless steel
- Finish: Brushed Stainless Steel (SS)
- Holds up to 560 lbs. per pair of brackets
- Lever lock for easy installation, stability and safety
- Predrilled holes for mounting 1987 series shelving or attaching shelf rests
- Two or three complete locking teeth
- Packed 10 brackets per box. Available any quantity.

186 Series Stainless Steel Brackets	
Length	Item #
8"	KV186SS-8
10"	KV186SS-10

187 Series Stainless Steel Brackets	
Length	Item #
12"	KV187SS-12
16"	KV187SS-16
18"	KV187SS-18
24"	KV187SS-24

KV 71/170 REGULAR-DUTY STANDARDS & BRACKETS



KV 71 Series Narrow Standards



- Single slot system
- 1" vertical slot adjustment
- BHMA Grade 2 Compliant
- Limited lifetime warranty
- Dimensions: 5/16" wide x 13/32" deep x selected length
- Material: 13 gauge steel
- Finish: Anochrome (ANO)
- Narrow design to fit between prefabricated wall panels for flush wall mount
- Countersunk screw holes
- Center aligned slots and screw holes
- Precision cut lengths
- Packed in boxes of 10 per box. Available any quantity.

Length	Item #
48"	KV71-48
72"	KV71-72
96"	KV71-96



KV 170 Series Brackets

- For use with KV 71 series narrow standards
- Material: 14 gauge steel
- Finish: Anochrome (ANO)
- Holds up to 210 lb per pair
- Two locking teeth
- Shelf retaining clip
- Stamped wing stabilizer
- Packed in boxes of 50 per carton. Available any quantity.

Length	Item #
12"	KV170A-12
14"	KV170A-14

A
B
C
D
E
F
G
H
I
J
K
L
M
N
O
P
Q
R
S
T
U
V
W
X
Y

A
B
C
D
E
F
G
H
I
J
K
L
M
N
O
P
Q
R
S
T
U
V
W
X
Y

KV 85 / 185 SERIES EXTRA-DUTY STANDARDS & BRACKETS



Anochrome

White

KV 85 Series Standards

- Double slot design
- 1" vertical slot adjustability
- BHMA Grade 2 Compliant
- Limited lifetime warranty
- Dimensions: 1-1/4" wide x 1/2" deep x selected length
- Material: 16 gauge steel
- Finish: Anochrome (ANO), White (WH)
- Safety lead-in at top of standard
- Embossed logo to show correct orientation
- Countersunk screw holes
- Center aligned slots and screw holes
- Precision cut lengths
- Packed 10 standards per box. Available any quantity.



Length	Anochrome Item #	White Item #
24"	KV85A-24	KV85WH-24
36"	KV85A-36	KV85WH-36
48"	KV85A-48	KV85WH-48
60"	KV85A-60	KV85WH-60
72"	KV85A-72	KV85WH-72
84"	KV85A-84	KV85WH-84
96"	KV85A-96	KV85WH-96



Anochrome

White

KV 185 Series Brackets

- For use with KV 85 series standards
- Material: 14 and 16 gauge steel
- Finish: Anochrome (ANO), White (WH)
- Holds up to 680 lbs. per pair of brackets
- Shelf retaining lip on brackets
- Four locking teeth and two lugs for safety and stability
- Shelf fastening screw holes
- Packed 10 brackets per box. Available any quantity.



Length	Anochrome Item #	White Item #
8"	KV185A-8	KV185WH-8
10"	KV185A-10	KV185WH-10
12"	KV185A-12	KV185WH-12
14"	KV185A-14	KV185WH-14

Length	Anochrome Item #	White Item #
16"	KV185A-16	KV185WH-16
18"	KV185A-18	KV185WH-18
20"	KV185A-20	KV185WH-20
22"	KV185A-22	KV185WH-22
24"	KV185A-24	KV185WH-24

KV 85 / 185 SERIES STANDARD & BRACKET ACCESSORIES



KV 106 Shelf Rest

- Used to join two shelves at one bracket
- Finish: Anochrome
- Packed 50 per box. Available any quantity.

Item #
KV106ANO



KV 107 Hang Rod Clamp

- Bolts for 183 and 185 brackets to hold rods securely
- Finish: Anochrome
- Packed 20 per box. Available any quantity.

Item #
KV107ANO



KV 113L/113R Panel Clips

- Used to attach display and wall panels into vertical position
- Finish: Anochrome
- Packed 50 per box. Available any quantity.

Item #	Description
KV113L-ANO	Left-Hand Anochrome Panel Clip
KV113R-ANO	Right-Hand Anochrome Panel Clip



KV 129 Gray Rubber Cushion

- For use with metal and plastic rests
- Packed 100 per box. Available any quantity.

Item #
KV129



KV 159 Lock Lever Heavy-Duty Support Bracket

- Provides extra support for shelves with heavy loads
- Lever lock for extra secure mounting and stability
- Finish: Anochrome
- Packed 100 per box. Available any quantity.

Item #
KV159LL-ANO



KV 191/192 Hang Rod Saddles

- 191 bolts to 183L & 183R or 185 brackets to hold 1-1/16" O.D. tubing
- 192 bolts to 183L & 183R or 185 brackets to hold 1-5/16" O.D. tubing
- Finish: Anochrome
- Packed 10 per box. Available any quantity.

Item #	Description
KV191ANO	To hold 1-1/16" O.D. tubing
KV192ANO	To hold 1-5/16" O.D. tubing



A
B
C
D
E
F
G
H
I
J
K
L
M
N
O
P
Q
R
S
T
U
V
W
X
Y

A
B
C
D
E
F
G
H
I
J
K
L
M
N
O
P
Q
R
S
T
U
V
W
X
Y

KV 82/182 SERIES HEAVY-DUTY STANDARDS & BRACKETS

KV 82 Series Standards

- Double slot design
- 1-1/4" vertical slot adjustability
- BHMA Grade 2 Compliant
- Limited lifetime warranty
- Dimensions: 1-1/16" W x 11/16" D x selected length
- Material: 14 gauge steel
- Strength enhancing ribs
- Countersunk screw holes
- Embossed "up" and arrow to show correct orientation
- Center aligned slots and screw holes
- Precision cut lengths
- Packed 10 standards per box. Available any quantity.



Almond Black Titanium White



Length	Almond Item #	Black Item #	Titanium Item #	White Item #
16.5"	—	KV82BPBLK-16	—	KV82BPWH-16
28"	—	KV82BPBLK-28	KV82BPTI-28	KV82BPWH-28
39"	KV82BPALM-39	KV82BPBLK-39	KV82BPTI-39	KV82BPWH-39
48"	KV82BPALM-48	KV82BPBLK-48	KV82BPTI-48	KV82BPWH-48
63"	—	KV82BPBLK-63	KV82BPTI-63	KV82BPWH-63
78"	KV82BPALM-78	KV82BPBLK-78	KV82BPTI-78	KV82BPWH-78
94"	—	KV82BPBLK-94	KV82BPTI-94	KV82BPWH-94

KV 182 Series Brackets

- For use with KV 82 series standards
- Material: 16 gauge steel
- Holds up to 450 lbs. per pair of brackets
- Four complete locking teeth
- Countersunk screw holes to fasten shelves
- Packed 10 brackets per box. Available any quantity.



Almond



Titanium



Black



White

Length	Almond Item #	Black Item #	Titanium Item #	White Item #
5"	—	KV182BPBLK-5	—	KV182BPWH-5
7"	KV182BPALM-7	KV182BPBLK-7	KV182BPTI-7	KV182BPWH-7
9"	KV182BPALM-9	KV182BPBLK-9	KV182BPTI-9	KV182BPWH-9
10.5"	KV182BPALM-10	KV182BPBLK-10	KV182BPTI-10	KV182BPWH-10
12.5"	KV182BPALM-12	KV182BPBLK-12	KV182BPTI-12	KV182BPWH-12
14.5"	KV182BPALM-14	KV182BPBLK-14	KV182BPTI-14	KV182BPWH-14
18.5"	—	KV182BPBLK-18	KV182BPTI-18	KV182BPWH-18
24"	—	KV182BPBLK-24	KV182BPTI-24	KV182BPWH-24



KV 82/182 SERIES STANDARD & BRACKET ACCESSORIES



KV 182 Bookend

- Finish: White (WH)
- Packed 10 pairs per box. Available any quantity.



Length	Item #
9"	KV182BEWH-9
10"	KV182BEWH-10



KV 82 Screw Pack

- Finish: Zinc
- Packed 20 bags per box (6 screws + 6 anchors per bag). Available any quantity.



Item #
KV82SCRW



KV 182 Shelf Locator/Joiner

- Finish: Clear plastic
- Packed 20 bags per box (4 joiners + 8 screws per bag). Available any quantity.



Item #
KV182LOCATOR



KV 182 Bracket Lock

- Finish: Black rubber
- Packed 20 bags per box (6 locks per bag). Available any quantity.



Item #
KV182LOCK

A
B
C
D
E
F
G
H
I
J
K
L
M
N
O
P
Q
R
S
T
U
V
W
X
Y

A
B
C
D
E
F
G
H
I
J
K
L
M
N
O
P
Q
R
S
T
U
V
W
X
Y

KV 255 SERIES STEEL AND ALUMINUM PILASTERS

KV 255 Series Steel Pilasters

- Holds up to 500 lbs. per shelf
- 1/2" vertical slot adjustment
- Full finish coverage to deter corrosion
- BHMA Grade 1 Compliant
- Dimensions: 5/8" width x 3/16" deep x selected length
- Material: 23 gauge high strength steel
- 12" - 60" sizes packed 100 standards per carton.
- 72 - 96" sizes packed 50 standards per carton.

Available any quantity.

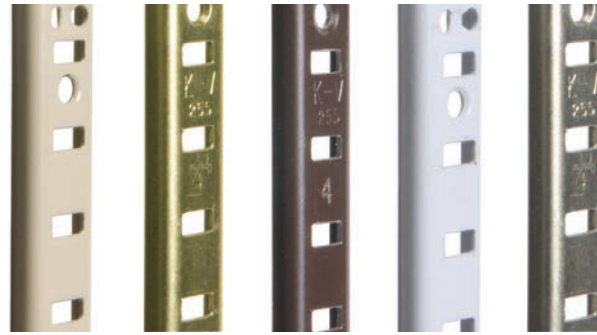

Almond Brass-look Brown White Zinc



Length	Almond Item #	Brass-Look Item #	Brown Item #	White Item #	Zinc Item #
12"	KV255ALM-12	—	—	KV255WH-12	KV255ZC-12
18"	KV255ALM-18	KV255BR-18	KV255BRN-18	KV255WH-18	KV255ZC-18
24"	KV255ALM-24	KV255BR-24	KV255BRN-24	KV255WH-24	KV255ZC-24
30"	KV255ALM-30	—	—	KV255WH-30	KV255ZC-30
36"	KV255ALM-36	KV255BR-36	KV255BRN-36	KV255WH-36	KV255ZC-36
42"	—	—	—	—	KV255ZC-42
48"	KV255ALM-48	KV255BR-48	KV255BRN-48	KV255WH-48	KV255ZC-48
60"	KV255ALM-60	KV255BR-60	KV255BRN-60	KV255WH-60	KV255ZC-60
72"	—	KV255BR-72	KV255BRN-72	KV255WH-72	KV255ZC-72
84"	KV255ALM-84	KV255BR-84	—	KV255WH-84	KV255ZC-84
96"	KV255ALM-96	KV255BR-96	KV255BRN-96	KV255WH-96	KV255ZC-96



Natural Aluminum Brass-look Walnut

KV 255 Series Aluminum Pilasters

- Holds up to 500 lbs. per shelf
- Material: 17 gauge aluminum
- 12" - 60" sizes packed 100 standards per carton.
- 72 - 96" sizes packed 50 standards per carton. Available any quantity.



Length	Natural Aluminum Item #	Brass-Look Item #	Walnut Item #
12"	KV255AL-12	KV255ALBR-12	—
18"	KV255AL-18	KV255ALBR-18	KV255ALWAL-18
24"	KV255AL-24	KV255ALBR-24	KV255ALWAL-24
30"	KV255AL-30	KV255ALBR-30	KV255ALWAL-30
36"	KV255AL-36	KV255ALBR-36	KV255ALWAL-36
48"	KV255AL-48	KV255ALBR-48	KV255ALWAL-48
60"	KV255AL-60	KV255ALBR-60	KV255ALWAL-60
72"	KV255AL-72	KV255ALBR-72	—
84"	KV255AL-84	—	—
96"	KV255AL-96	KV255ALBR-96	—

KV 255/256 SERIES SHELF SUPPORTS & ACCESSORIES

KV 256 Series Pilaster Shelf Supports

- For use with 255 series steel and aluminum pilasters
- Material: High strength steel
- Patented design
- Full coverage finish to resist corrosion
- Strength increasing dimple
- * Use 256WAL with 255 BRN and 255 AL WAL

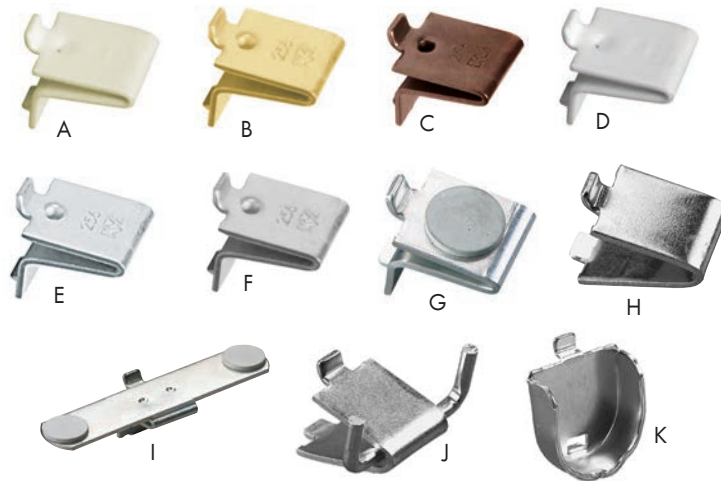

	Item #	Description	Finish	Box Qty
A	KV256ALM	Shelf support	Almond	100
B	KV256BR	Shelf support	Brass-look	100
	KV256BR-M	Shelf support	Brass-look	1000
C	KV256WAL	Shelf support	Walnut*	100
	KV256WAL-M	Shelf support	Walnut*	1000
D	KV256WH	Shelf support	White	100
E	KV256ZC	Shelf support	Zinc	100
	KV256ZC-M	Shelf support	Zinc	1000
F	KV256ALNAT	Shelf support	Natural Aluminum	100
G	KV256R	Shelf support with rubber cushion	Zinc	100
H	KV239ZC	Shelf support - Woodwork Institute Acknowledged Product	Zinc	100
I	KV243ZC	3" shelf bracket (non-handed)	Zinc	100
J	KV244ANO	Wire shelf support	Zinc	100
K	KV757	Flange for 1-1/16" OD closet rod	Zinc	100



Nails for KV 255 Series Pilasters

- Approximately 650 nails per bag



Item #	Finish	Use with:
KV255-8ALM	Almond	255ALM
KV255-8BR	Brass-look	255BR, 255AL BR
KV255-8STB	Bronzed	255BRN, 255AL BRN, 255AL WAL
KV255-8WH	White	255WH
KV255-8ZC	Zinc	255ZC, 255AL

A KV 233 PILASTERS & ACCESSORIES



Zinc

Brass-look

KV 233 Surface Mount Steel Pilasters



- Holds up to 500 lb per shelf
- 1/2" vertical slot adjustability
- BHMA Grade 1 Compliant
- Limited lifetime warranty
- Dimensions: 13/16" width x 3/16" deep x selected height
- Material: 23 gauge high-strength steel
- Numbered slots for quick, accurate clip insertion
- Countersunk nail, screw and staple holes
- Full finish coverage to deter corrosion
- Precision cut lengths
- 18" - 60" sizes packed 100 standards per carton. Available any quantity.
- 72" - 96" sizes packed 50 standards per carton. Available any quantity.

Length	Zinc Item #	Brass Look Item #
18"	KV233ZC-18	—
24"	KV233ZC-24	—
30"	KV233ZC-36	—
36"	KV233ZC-42	—
48"	KV233ZC-48	—
60"	KV233ZC-60	—
72"	KV233ZC-72	KV233BR-72
84"	KV233ZC-84	—
96"	KV233ZC-96	KV233BR-96

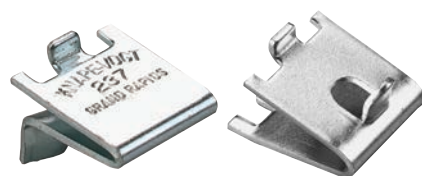

KV237ZC

KV238

KV 233 Pilaster Shelf Supports



Item #	Description	Finish
KV237ZC	Shelf support for 233 pilasters	Zinc
KV238	Shelf support with locator tab	Zinc



Nails for KV 233 Series Pilasters



- Approximately 650 nails per bag

Item #	Finish	Use with:
KV255-8BR	Brass-look	233BR
KV255-8ZC	Zinc	233ZC

REEVE HEAVY DUTY SHELF STANDARD & BRACKET



**Heavy Duty Shelf Standard
Concealed/Recessed**



- Used with RV767 series bracket
- 1-1/2" W x 11/16" D
- Brillatone (Zinc)
- .125" thick cold rolled steel
- Adjustable in 2" increments
- Screwholes 6" centers staggered each side
- Recommended fasteners (sold separately): #10 Flat Head screw

Packed: 10 standards per box. Available any quantity.

Length	Item #
72"	RV704ZC-72
96"	RV704ZC-96

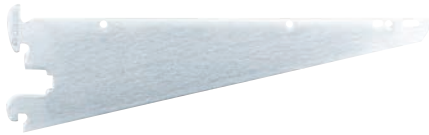

**Heavy Duty Shelf Bracket
For Concealed/Recessed Standards**



- Used with RV704 series standard
- 1/8" thick tempered steel
- Brillatone (Zinc)
- Weight rating of 675 to 1,325 lbs. per pair (based on length)
- Bracket features two engagement teeth, top tooth has uphook design to increase bracket's hold to the standard

Packed: 24 brackets per box. Available any quantity.

Length	Item #
10"	RV767ZC-10
12"	RV767ZC-12
14"	RV767ZC-14
16"	RV767ZC-16
18"	RV767ZC-18

A
B
C
D
E
F
G
H
I
J
K
L
M
N
O
P
Q
R
S
T
U
V
W
X
Y

A
B
C
D
E
F
G
H
I
J
K
L
M
N
O
P
Q
R
S
T
U
V
W
X
Y

REEVE SINGLE SLOT STANDARDS



Standard Duty Shelf Standard Single Slotted, 11/16" W



- Used with RV41, RV43, RV81 and RV83 series brackets
 - Brillatone (Zinc)
 - .0625" thick cold rolled steel
 - Adjustable in 1" increments
 - Screwholes on 6" centers
 - Recommended Fasteners (sold separately): #7 Flat Head screw
- Packed: 10 standards per box. Available any quantity.

Length	Item #
24"	RV40ZC-24
30"	RV40ZC-30
36"	RV40ZC-36
48"	RV40ZC-48
60"	RV40ZC-60
72"	RV40ZC-72
84"	RV40ZC-84
96"	RV40ZC-96



Heavy Duty Shelf Standard Single Slotted, 11/16" W



- Used with RV41, RV43, RV81 and RV83 series brackets.
 - Brillatone (Zinc)
 - .090" thick cold rolled steel
 - Adjustable in 1" increments
 - Screwholes on 12" centers
 - Recommended Fasteners (sold separately): #7 Flat Head screw
- Packed: 10 standards per box. Available any quantity.

Length	Item #
24"	RV20ZC-24
36"	RV20ZC-36
48"	RV20ZC-48
60"	RV20ZC-60
72"	RV20ZC-72
84"	RV20ZC-84
96"	RV20ZC-96

REEVE SINGLE SLOT BRACKETS

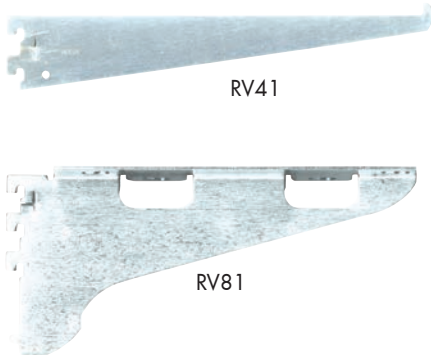

**Standard & Heavy Duty Shelf Brackets
With & Without Flange**



- Used with RV20 & RV40 series standards
- Brillatone (Zinc)
- RV41 is .080" thick tempered steel, RV81 is .085" thick tempered steel
- Weight rating: 130-350 lbs. (RV41), 200-450 lbs. (RV81) per pair
- RV41 has a shelf lip at the end of the bracket with no flange, RV81 is available in left, right and center flange styles
- Brackets are designed with stabilizers to reduce sway
- RV41 has two engagement teeth, while RV81 has three

Standard Duty - RV41 (Without Flange)	
Length	Item #
4"	RV41ZC-4
6"	RV41ZC-6
8"	RV41ZC-8
10"	RV41ZC-10
12"	RV41ZC-12
14"	RV41ZC-14
16"	RV41ZC-16
18"	RV41ZC-18

Heavy Duty - RV81 (With Flange) Brillatone-Zinc Finish			
Length	Right Flange Item #	Left Flange Item #	Center Flange Item #
8"	RV81RZC-8	RV81LZC-8	RV81CZC-8
10"	RV81RZC-10	RV81LZC-10	RV81CZC-10
12"	RV81RZC-12	RV81LZC-12	RV81CZC-12

Packed: RV41 series 24 brackets per box;
RV81 series 12 brackets per box.
Both are available any quantity.

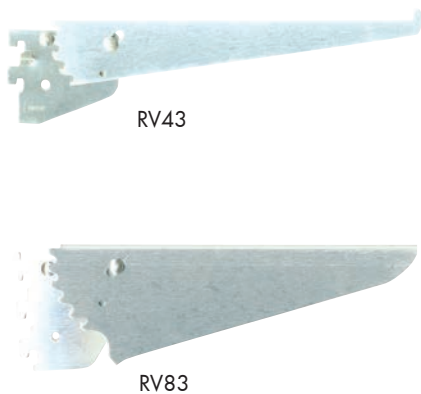

**Standard Duty Shelf Brackets
Adjustable Downslant, With & Without Flange**



- Used with RV20 & RV40 series standards
- .080" thick tempered steel
- Brillatone- (Zinc)
- Weight rating of: 50 lbs. per pair (for both RV43 & RV83)
- Adjusted to straight, 7°, 15°, 30°, 45° downslants, (14" & 16" length can be adjusted to 60° downslant)
- RV43 has two engagement teeth and a shelf lip
- RV83 comes in left and right flange versions and has three engagement teeth

Packed: 12 brackets per box. Available any quantity.

Sold In: Both broken and full box quantities. Discount available for full box orders.

RV43 (Without Flange)	
Length	Item #
10"	RV43ZC-10
12"	RV43ZC-12
14"	RV43ZC-14

RV83 (With Flange)		
Length	Right Flange Item #	Left Flange Item #
8"	RV83RZC-8	RV83LZC-8
10"	RV83RZC-10	RV83LZC-10
12"	RV83RZC-12	RV83LZC-12
14"	RV83RZC-14	RV83LZC-14
16"	RV83RZC-16	RV83LZC-16

A
B
C
D
E
F
G
H
I
J
K
L
M
N
O
P
Q
R
S
T
U
V
W
X
Y

A
B
C
D
E
F
G
H
I
J
K
L
M
N
O
P
Q
R
S
T
U
V
W
X
Y

REEVE SINGLE SLOT STANDARDS

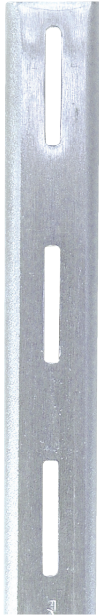

Extra Heavy Duty Shelf Standard Single Slotted, 7/8" W x 5/8" D



- Used with RV723 & RV766 Series bracket
- Brillatone (Zinc)
- .125" thick cold rolled steel
- Adjustable in 2" increments; Screwholes 12" on centers
- Recommended Fasteners: RV710ZC Series - #10 wood screw; RV700ZC Series - RV14

Packed: 10 standards per box. Available any quantity.

Length	#10 Screwhole Item #	#14 Screwhole Item #
36"	RV710ZC-36	RV700ZC-36
48"	RV710ZC-48	RV700ZC-48
60"	RV710ZC-60	RV700ZC-60
72"	RV710ZC-72	RV700ZC-72

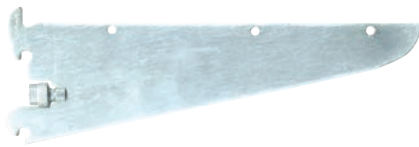

Extra Heavy Duty Shelf Bracket Single Slotted



- Used with RV700 Series standard
- Brillatone (Zinc)
- 1/8" thick tempered steel; Weight rating of 675 to 1,325 lbs. per pair (based on length)
- Bracket comes standard with locknut thumb screw to reduce sway
- Two engagement teeth, one tooth has an uphook design for additional stability and holding power

Packed: 12 brackets per box. Available any quantity.

Length	Item #
8"	RV766ZC-8
10"	RV766ZC-10
12"	RV766ZC-12

Length	Item #
14"	RV766ZC-14
16"	RV766ZC-16
18"	RV766ZC-18

Length	Item #
20"	RV766ZC-20
22"	RV766ZC-22
24"	RV766ZC-24

For Heavy Duty Flanged Brackets, see next page ►

REEVE FLANGED BRACKETS/DOUBLE SLOTTED STANDARDS/BRACKETS

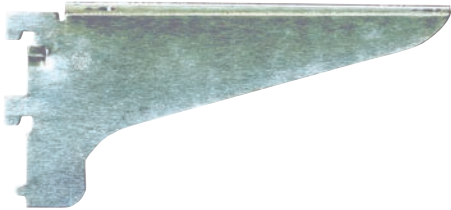

**Extra Heavy Duty Shelf Bracket
Single Slotted Flanged Bracket**



- Used with RV700 Series standard
- Brillatone (Zinc)
- .085" thick tempered steel; Weight rating: 230-520 lbs. per pair (based on length).
- Flange has keyhole slots for shelf mounting.
- Bracket has two engagement teeth and stabilizer tooth (to reduce sway) to secure bracket to standard.

Packed: 12 brackets per box. Available any quantity.

Length	Right Flange Item #	Left Flange Item #	Center Flange Item #
12"	RV723RZC-12	RV723LZC-12	RV723CZC-12
14"	RV723RZC-14	RV723LZC-14	RV723CZC-14
16"	RV723RZC-16	RV723LZC-16	RV723CZC-16



**Heavy Duty Standard
Double Slotted, 1-1/4" W x 1/2" D**



- Used with RV485 series bracket
- Brillatone (Zinc)
- .074" thick steel
- Adjustable in 1" increments.
- Screwholes are placed 6" apart on centers.
- Recommended Fasteners (sold separately): #10 Flat Head screw.

Packed: 10 standards per box. Available any quantity.

Length	Item#
36"	RV44ZC-36
48"	RV44ZC-48



Heavy Duty Bracket Double Slotted



- Used with RV44 series standard
- Brillatone (Zinc)
- .080" thick cold rolled steel (based on size).
- Weight rating of 335-710 lbs. per pair (based on length)
- Bracket has 2 engagement teeth to fasten standard to bracket and shelf lip at end of bracket
- For use in long runs of shelving

Packed: 10 brackets per box. Available any quantity.

Length	Item #
10"	RV485ZC-10
12"	RV485ZC-12

Length	Item #
14"	RV485ZC-14
16"	RV485ZC-16

A
B
C
D
E
F
G
H
I
J
K
L
M
N
O
P
Q
R
S
T
U
V
W
X
Y

A
B
C
D
E
F
G
H
I
J
K
L
M
N
O
P
Q
R
S
T
U
V
W
X
Y

REEVE ACCESSORIES

Steel Shelf Rests, Sockets, and Rubber Cushions

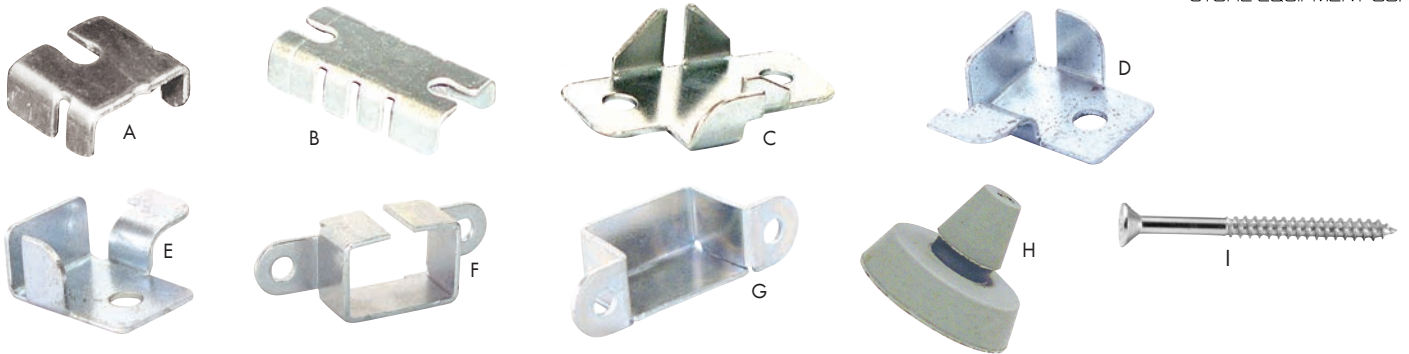

* = Sold in full boxes only.

Item#	Description	Box Qty	Finish
A	RV43ZC-1 Use with right or left RV81 Series Brackets, RV4 Rubber Cushions included	144	Brillatone (Zinc)
B	RV43ZC-2 Use with RV41, 43, 81CZC and 485 Series Brackets, RV4 Rubber Cushions included	144	Brillatone (Zinc)
C	RV743CZC Center Shelf Rest supports with mounting holes, RV4 Rubber Cushions included	144	Brillatone (Zinc)
D	RV743LZC Left Shelf Rest supports with mounting holes, RV4 Rubber Cushions included	144	Brillatone (Zinc)
E	RV743RZC Right Shelf Rest supports with mounting holes, RV4 Rubber Cushions included	144	Brillatone (Zinc)
F	RV49ZC-B Bottom Socket for stabilizing RV20/40 Series Standards	100	Brillatone (Zinc)
G	RV49ZC-T Top Socket for stabilizing RV20/40 Series Standards	100	Brillatone (Zinc)
H	RV4 Rubber Cushion, 1/2" diameter, suction surface holds glass in place	100*	Gray
I	RV14 Flat Head Phillips Screws, #14 x 3" (50 pack)	1	Zinc



Shelf Bracket For Slatwall



- 14 gauge backplate, tempered steel bracket
- Finish: Chrome

Item#	Length
RV108CHR-10	10"
RV108CHR-12	12"
RV108CHR-14	14"



1/4" Diameter Hook For Slatwall



- 14 gauge cold rolled steel, 1"W
- Finishes: Chrome and Zinc

Length	Chrome Item#	Zinc Item #
4"	RV91CHR-4	RV91ZC-4
6"	RV91CHR-6	RV91ZC-6
8"	RV91CHR-8	RV91ZC-8